

# SENSOR THERMOWELLS

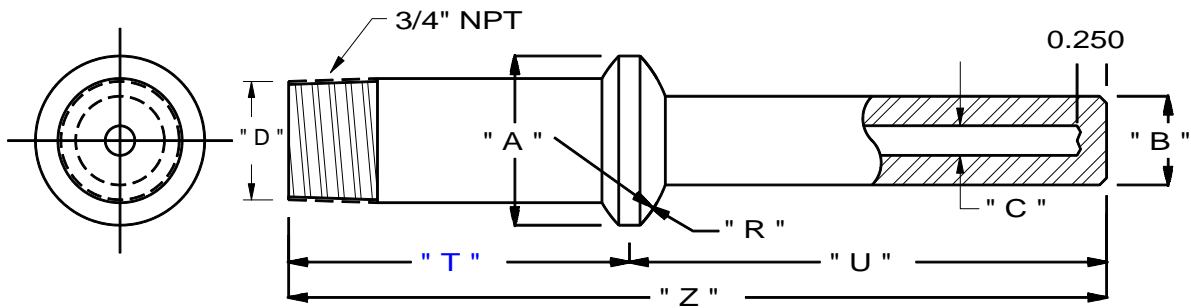

## GROUND JOINT- STRAIGHT, BARSTOCK

PART NO.	" A " * FACE DIA	" B " * STEM DIA.	" D " * DIA.	" C " * BORE	" T " * STANDARD
810S	PER Ring Size	1.0"	1.05"	.500"	2.88"
816S	PER Ring Size	.88"	1.05"	.437"	2.88"
811S	PER Ring Size	.75"	1.05"	.390"	2.88"
812S	PER Ring Size	.62"	1.05"	.265"	2.88"
817S	PER Ring Size	1.0"	1.05"	.718"	2.88"

**HOW TO ORDER:**  
 "A" DIA. FOR "R" RADIUS = 1.00"  
 "A" DIA. FOR "R" RADIUS = 1.25"

PART NO.	MATERIAL (SEE TABLE)	RING SIZE	LENGTH " U "	LENGTH " T " IF DIFFERENT FROM STD.	OPTIONS AS REQUIRED
----------	-------------------------	--------------	--------------	--	------------------------

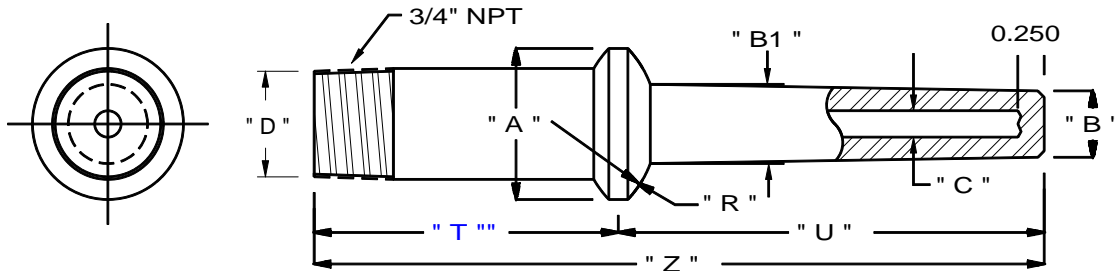

## GROUND JOINT- TAPERED, BARSTOCK

PART NO.	" A " * FACE DIA	" B " * STEM DIA.	" B1 " * STEM DIA.	" D " * DIA.	" C " * BORE	" T " * STANDARD
810T	PER Ring Size	1.0"	1.25"	1.05"	.500"	2.88"
816T	PER Ring Size	.88"	1.25"	1.05"	.437"	2.88"
811T	PER Ring Size	.75"	1.25"	1.05"	.390"	2.88"
812T	PER Ring Size	.62"	1.25"	1.05"	.265"	2.88"
817T	PER Ring Size	1.0"	1.25"	1.05"	.718"	2.88"

**HOW TO ORDER:**  
 "A" DIA. FOR "R" RADIUS = 1.00"  
 "A" DIA. FOR "R" RADIUS = 1.25"

PART NO.	MATERIAL (SEE TABLE)	RING SIZE	LENGTH " U "	LENGTH " T " IF DIFFERENT FROM STD.	OPTIONS AS REQUIRED
----------	-------------------------	--------------	--------------	--	------------------------